





## Available Headstyles

Headstyles	Diameter • Plating
C 	0,90C • Au
D 	0,50C • Au
H 	0,50 • Au 0,90C • Au
Q 	0,50 • Au
V 	0,50 • Au
V1 	0,50 • Au
VL2 	0,50 • Au

## Series 1008/E

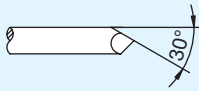
### Mechanical

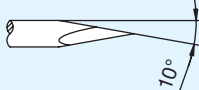
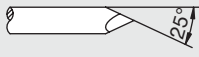
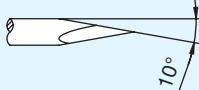
Spacing	<b>1,27 mm/50 mil</b>
Full travel	<b>6,40 mm</b>
Recommended working travel	<b>4,30 mm</b>
Pre-loaded spring force	<b>0,30/0,40/0,50 N</b>
Spring force at working travel	<b>1,00/1,50/2,00 N</b>

### Electrical

max. current rating	<b>2,0-3,0 A</b>
Typ. continuity resistance	<b>≤ 20 mOhm</b>

### Materials

Barrel	<b>bronze, gold plated</b>
Spring	<b>spring steel, gold plated</b>
Plunger	<b>steel or CuBe</b>
Receptacle	<b>bronze, gold plated</b>

### Recommended Diameter of Drill

HP 2361.1 (Trolitax)	<b>0,95 ... 0,96 mm</b>
with inserted press ring	<b>1,02 mm</b>
HGW 2372	<b>0,96 ... 0,97 mm</b>
with inserted press ring	<b>1,03 mm</b>

## How to order:

**1008/E - C - 1,5 N - Au - 0,9 C**

Series

Headstyle

Contact Pressure

Plating

Tip Diameter (mm)

Tip Material: CuBe

## Dimensions and Mounting Measures

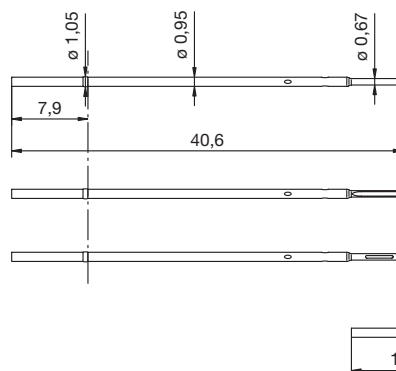
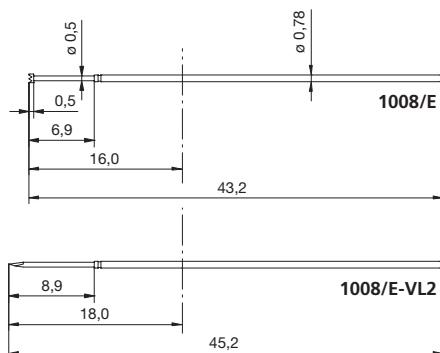

H 1008/E

H 1008/E-L

H 1008/E-ST

ST 1008/E